

Stage Mount

Cbore to clear 1/4-20 bolt head
(#W drill $\phi 0.386 \nabla 0.260$)

slip fit for 0.91" dowel pin
(#41 drill $\phi 0.096 \nabla 0.30$)

1/4-20 clearance holes
(#F drill $\phi 0.257$ THRU)

4-40 tapped holes
(#43 drill $\phi 0.089$ THRU)

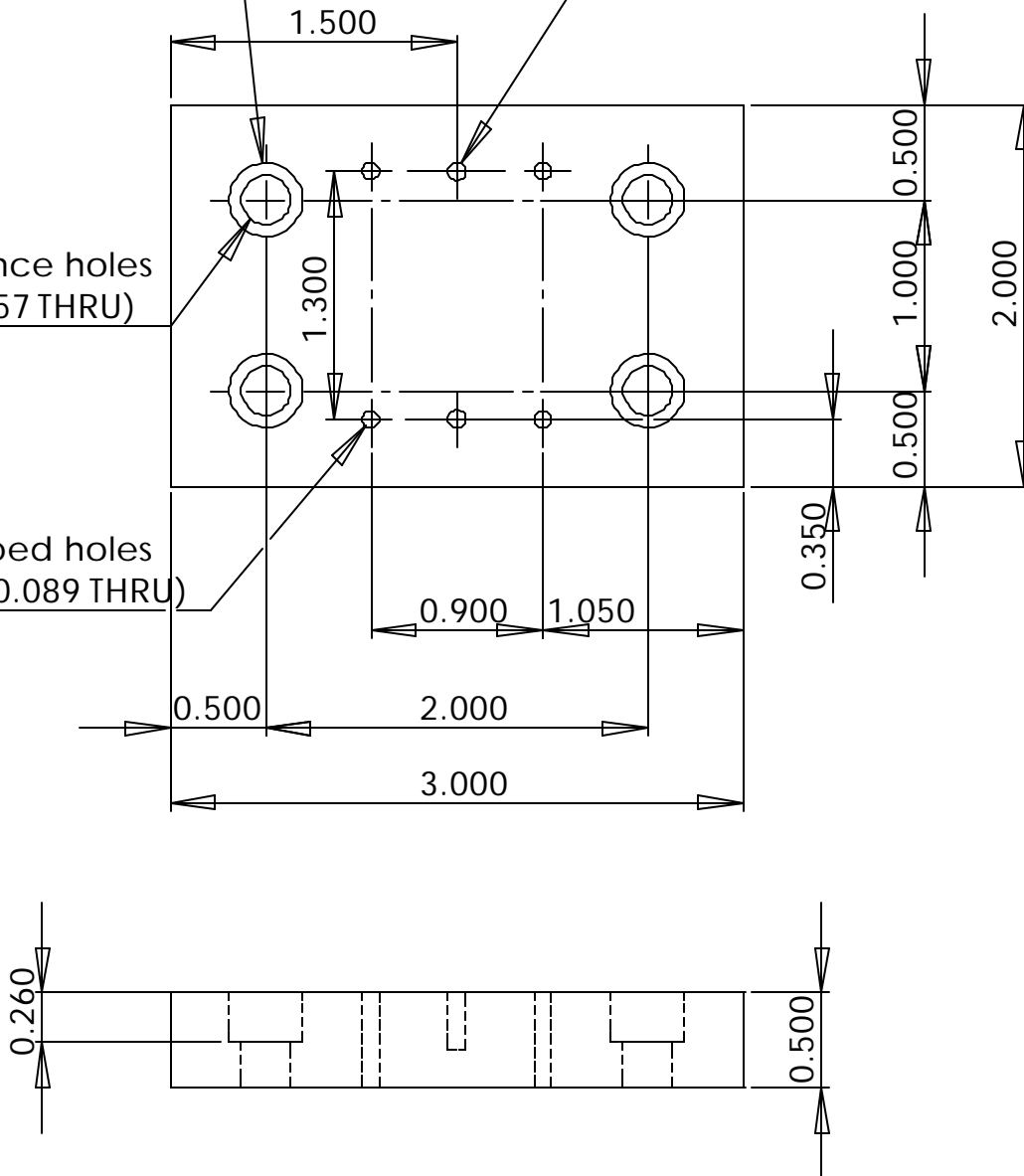

NOTES:

1. Drawing scale is 1:1 (all dimensions in inches)
2. Machine from 1/2" thick aluminum